

CIRCLINE MAGNIFYING LAMP - RLLE SERIES

Durable enough for industrial use; made for the Skin Care Specialist.

THE RLLE CIRCLINE MAGNIFYING LAMP PROVIDES SHADOW-FREE LIGHTING FOR EXAMINATIONS, SKIN CARE TREATMENTS AND OTHER DETAILED WORK. WALDMANN DESIGNS AND MANUFACTURES PRODUCTS THAT ALLOW MEDICAL AND

SKIN CARE SPECIALISTS TO EXPERIENCE TRUE QUALITY AND DURABILITY IN A MAGNIFYING LAMP. THE RLLE DESIGN ALLOWS THE USER TO ADJUST ITS POSITION EASILY, THEN STEADILY HOLDS THAT POSITION THROUGHOUT THE PROCEDURE.

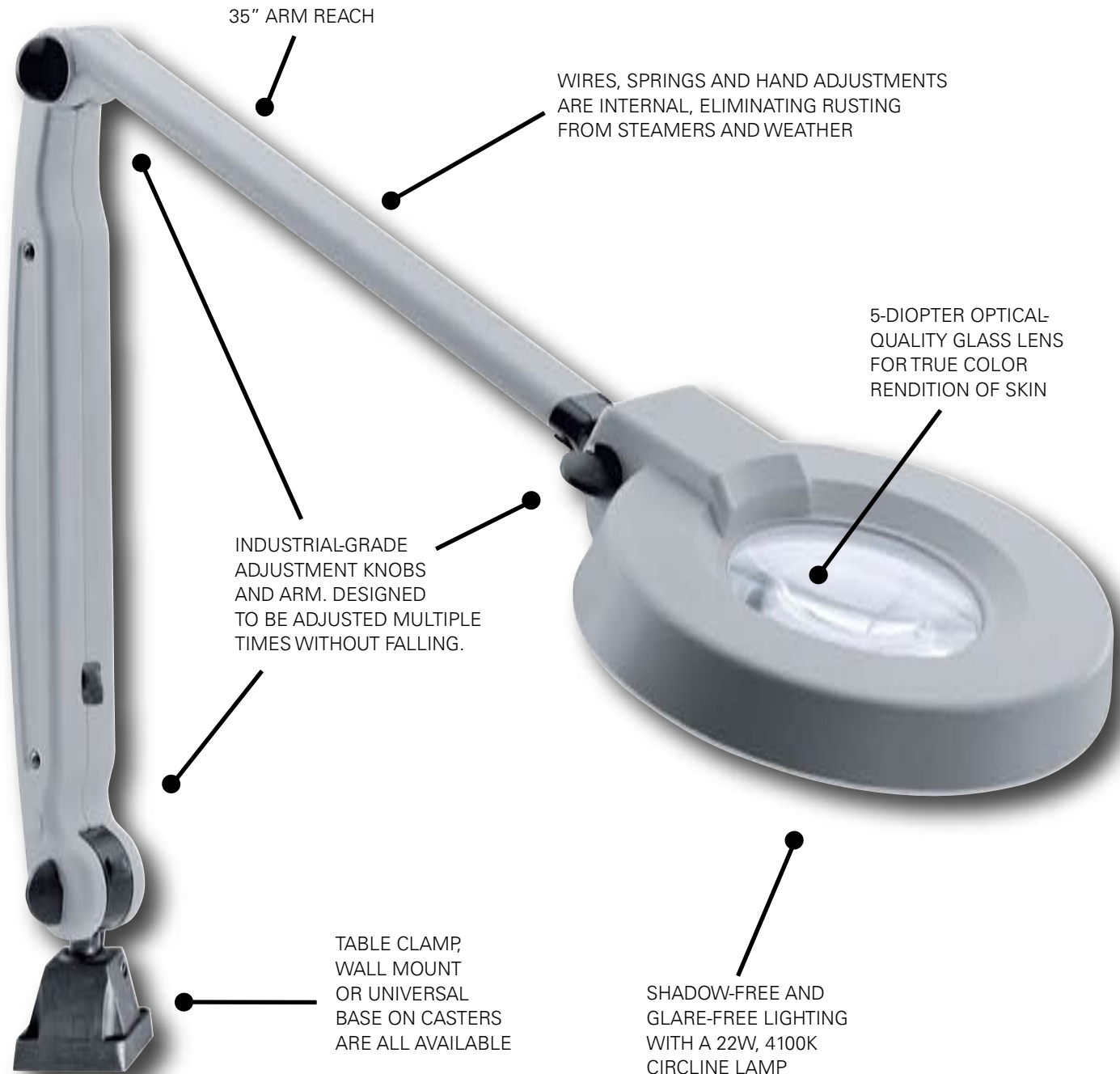

CIRCLINE MAGNIFYING LAMP - RLLE SERIES

Durable enough for industrial use; made for the Skin Care Specialist.

TECHNICAL SPECIFICATIONS

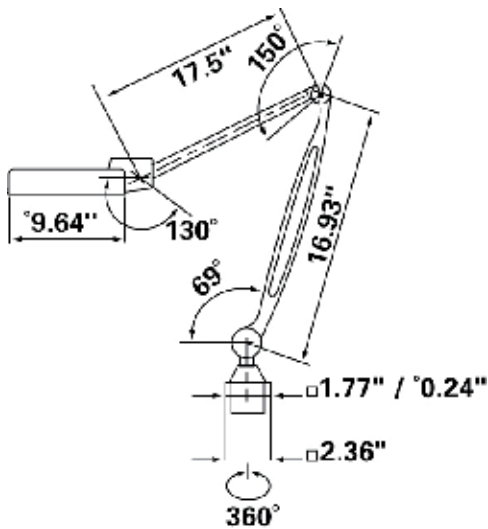

UNDERSTANDING MAGNIFICATION

RLLE-122 MAGNIFIER ACCESSORIES

This is the permanent 4d magnifier for both the standard and Max versions.

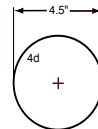

Model	Part #	4d Lens Part #
RLLE-122 4d Magnifier	138-442-000	Included

When added onto the permanent 4d magnifier your power increases to 8d.



Model	4d Add-X Lens Part #
RLLE-122	190-054-019

This is the permanent 4d+12d magnifier for both standard and Max versions.



Model	4d+12d Part #	4d+12d Lens Part #
RLLE-122 (4d+12d)	138-442-001	Included

When added on to the permanent 4d+12d magnifier your power increases to 8d+16d.

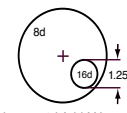

Model	4d Add-X Lens Part #
RLLE-122	190-054-019

UNDERSTANDING MAGNIFICATION:

To aid in your understanding of magnification, please refer to the following commonly used terms.

MAGNIFICATION (or POWER):

The degree to which the viewed object is enlarged. Magnification is expressed by a number followed by X (for example 4X).

DIOPTRER:

A term used to identify the light bending (refractive) capacity of a lens. It also relates magnification to focal distance. (See the chart below for diopter to power ratios.)

FOCAL DISTANCE:

This is the maximum distance from the center of the magnifying lens to the object being viewed, without distortion.

BASIC RULE TO REMEMBER:

As magnification increases, focal distance decreases and the size of the lens increases.

HELPFUL HINT:

To achieve maximum magnification without distortion, keep your eyes approximately 10" from the lens.

"SYSTEMS" MAGNIFICATION EXPLAINED:

The most often used measurement of magnification is "System Magnification." This formula measures not only the "power" of the lens, but also takes the seeing ability of the operator into consideration. This means that the operator is using the lens and therefore the refractive power of the eye, which is "1" is added into the formula.

Since we refer to magnification in diopters, it is useful to know how to equate diopters to power (X). The following formula is an easy way to calculate this:

$$\text{Magnification Power (X)} = \frac{\text{Diopter of lens} + 1 \text{ (Operator)}}{4}$$

$$\text{or, more simply: } X = \frac{D + 1}{4}$$

If we are using the "System Magnification" to equate diopters to power for the 3-diopter lens on the "Omnivue," our equation would look like this:

$$X = \frac{3 \text{ diopters} + 1}{4} = 1.75X$$

Magnification (X)	Diopter (D)	Focal Distance (Inches)
1.63	2.5	16
1.75	3	13.3
2	4	10
2.75	7	5.7
3	8	5
4	12	3.3
5	16	2.5

NOTE: For compliance with Military Specification, subtract 1X. The military does not consider the refractive power of the operator's eye in its formula.